

CONTROL
END BRACKET

R8 CLUTCH

ALUMINUM
ROLLER TUBE

IDLE END
PLUG

IDLE END
BRACKET

HEAT-WELDED
HEM POCKET

OPTIONAL
FABRIC WRAPPED
HEM BAR

STAINLESS STEEL
BEAD CHAIN

CHAIN
CONNECTOR

STOP BEAD

CHAIN GUIDE

Component Dimensions

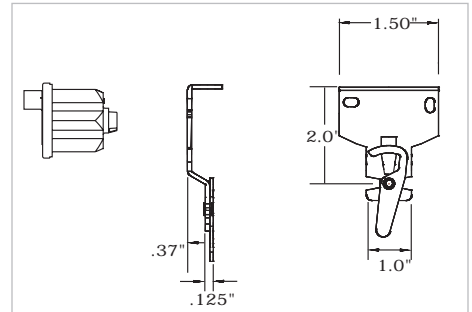
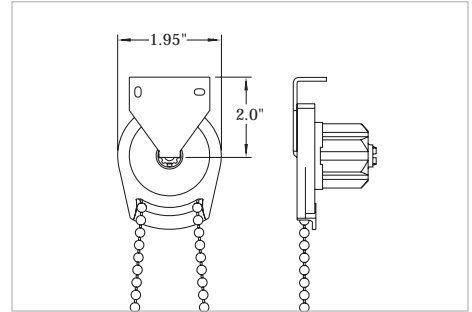
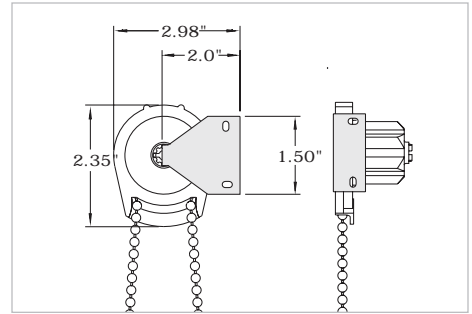

- R8 clutch system is designed to lift shades weighing up to eight pounds.
- Shades are raised and lowered by means of a #10 stainless steel bead chain.
- Roller tube is extruded aluminum engineered with a channel to accept fabric spline making the shade panel easy to remove.
- Hem bar is extruded aluminum and completely enclosed in a heat-welded hem pocket. Optional fabric wrapped hem bar.
- Edge gap is 9/16" on the clutch end and 9/16" on the idler end.



R8 Manual Shade

Project:		Date:	
Drawing #	MAS-1	Scale: Not to Scale	

EcoGreen Solar Shades, LLC.
 www.EcoGreenSolarShades.com • P: (877) 610-1555 F:(440) 233-1122